



V 1.0 - 092024

PeopleLink Dante Speaker



Key Features

- 30W power with 65Hz to 20kHz frequency response.
- 6-inch waterproof woofer and 1-inch adjustable silk dome tweeter.
- Peak sound output of 111dB with 8-ohm impedance.
- Fireproof engineering plastic and metal cabinet.
- Flexible suspension or flush mount installation with a 246mm round hole.

This 30W speaker features a 6-inch waterproof woofer and a 1-inch adjustable silk dome tweeter, providing a frequency range of 65Hz to 20kHz and a peak output of 111dB. With an 8-ohm impedance, it's housed in a fireproof engineering plastic and metal cabinet. It supports suspension or flush mounting with a 246mm round hole, includes a metal safety rope, and measures 279mm x 279mm x 176mm, weighing 3kg.

General Specifications

Power : 30W

Frequency Response (-10dB) : 65Hz - 20kHz

Output Boost (Peak) : 111dB

Impedance : 8 Ohms

Woofer : 6-Inch Composite Diaphragm Waterproof Unit

Tweeter : 1-Inch Silk Dome Tweeter, Angle Adjustable

Amplifier Cabinet Material : Engineering Plastic Metal Fireproof Cavity

Installation : Suspension and Flushing Mount

Opening Installation Dimensions : 246mm (Round Hole)

Accessories : Metal Safety Rope

Dimensions : 279mm x 279mm x 176mm

Weight : 3kg

Application Scenarios

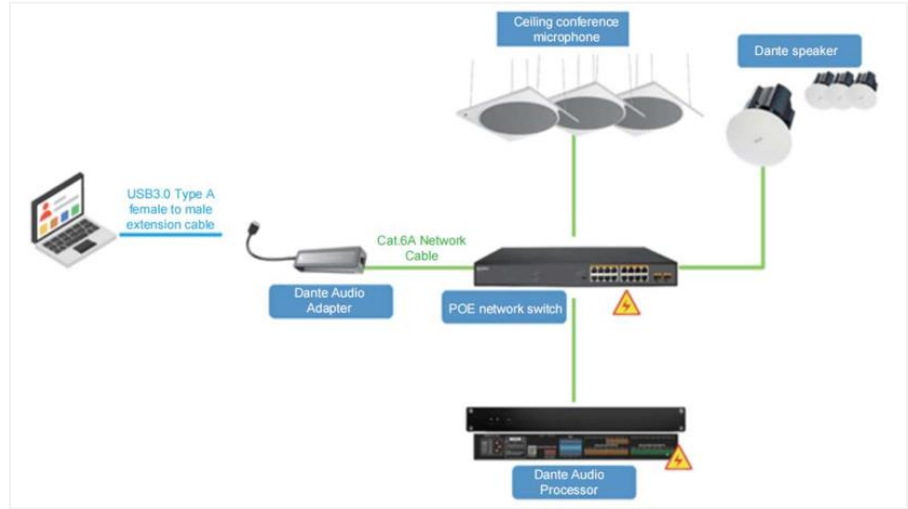
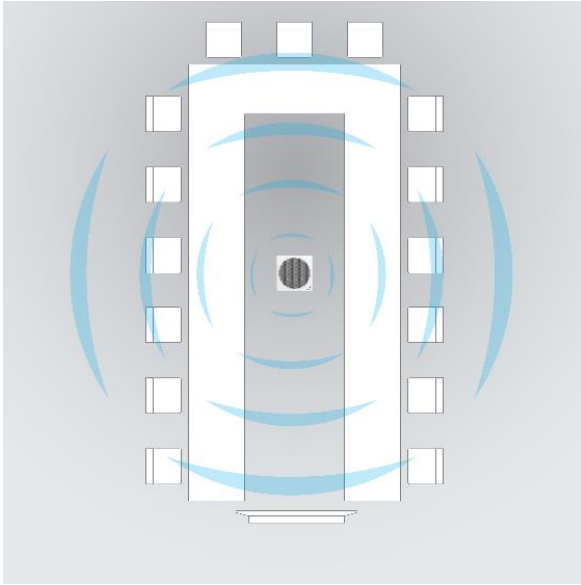

Disclaimer:- Room setup diagrams provided for reference only. Actual room setup and size may vary as per requirements.

Ordering Information

PeopleLink Dante Speaker : *****

SALES AND INQUIRIES

Global Headquarters

Q3-A3, 10th Floor Cyber Towers,
HITEC City, Hyderabad,
Telangana 500081, **India**
Phone: +91 9100123013
Email: vc@peoplelinkvc.com

International Contact Numbers

USA: +1 669-696-8383

Australia: +61 370 037070

France: +33 6 80 75 26 42

Middle East: +966 5300 19292

UK: +44 20 4571 5454

UAE: +971 4 3339082

Canada: +1 647-945-7373

Malaysia: +(6)018-2872188

New Zealand: +64-9-802-4666

Africa: +254 107 529 656

Tech Support

Toll Free: 1800 208 3399
customersupport@peoplelinkvc.com